

JAS-ANZ

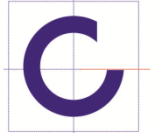

M5400913IN



# PROLIFIC ENGINEERS

**(AN ISO 9001:2015 Certified Company)**

**(Manufacturers of precision machined & fabricated parts)**

1

**Founded By:**

Satish Upadhyaya

In 2002

(B.E in Mech. Engg.)

30 Years Industrial Experience

# TABLE OF CONTENTS

S.NO.	CONTENT	PAGE
1	ABOUT US	3
2	LIST OF MACHINERY & EQUIPMENTS	4 & 5
3	IN-HOUSE CAPABILITIES	6
4	PARTNER CAPABILITIES	7
5	QUALITY ASSURANCE	8
6	LIST OF MEASURING INSTRUMENTS	9-10
7	HOW WE WORK	11
8	WHY CHOOSE US ?	12
9	VARIOUS COMPONENTS WE MANUFACTURE	13-24
10	INDUSTRIES WE ARE SERVING	25
11	OUR CLIENTELE	26-27
12	CONTACT US	28

# ABOUT US

- **Prolific Engineers (PE) (An ISO 9001-2015 certified company)** is leading manufacturer and supplier of precision machined and fabricated components under the leadership of our founder Mr. Satish Upadhyaya with more than 30 years of Industrial Experience.
- We provide total manufacturing solutions through the combination of our team of highly qualified and trained professionals who have years of experience in their respective field and our In-House fabrication and machining sections enable us to deliver components in a timely manner.
- Established in 2002, **Prolific Engineers (PE)** has always strived to produce and continually develop quality components with exacting tolerances at a competitive price.
- We have experience of working with different array of materials over the last 18 years like **Mild Steel ; Alloy Steels (EN8, EN9, EN19, EN24, EN26, EN31, EN36, EN42, EN353, SAE8620, HCHCRD2, HCHCRD3 etc) ; HSS ; Aluminum & its Alloys ; Brass & its Alloys; Stainless Steel (SS- (202,303,304,316,316L,410,420,440C,603 etc); All grades of Nylon; Different grades of Castings & Forgings.**
- We always strive to exceed our customer's delivery, stocking and quality expectation and are always on the lookout for new customers and have capabilities for expansion of Plant and Machinery as per our customer needs.

# LIST OF MACHINERY & EQUIPMENTS

- 4-Axis Vertical Machining Centre (VMC)- 800 x 600 x 600 mm- LML Ltd
- Vertical Machining Centre (VMC)- 850 x 650 x 650 mm- Manford Taiwan
- CNC Lathe- LML Ltd (Ø250 x 300 mm Length)
- CNC Lathe- LML Ltd (Ø300 x 800 mm Length)
- Lathe- 6 Nos From 6 ft to 16 ft (IIMC, Kirloskar, Nodo)
- Milling M1TR- Armstrong, Taiwan
- Milling Horizontal- Arno Italy
- Surface Grinder- 03 Nos- Guru Ram Das
- Centreless Grinder- Paragon, Taiwan
- Drill M/c- Parmar
- Tapping M/c- Kalsi
- Bandsaw- Veekay
- Profile Cutting- EsabIndia
- Gear Shaper- Axis, Italy
- TIG welding M/c- 02 Nos- EsabIndia
- Mig Welding M/c- Electra
- Hydro testing M/c- ME





**VMC**



**CNC LATHE**



**CENTERLESS GRINDER**



**HORIZONTAL MILLING**



**M1TR**

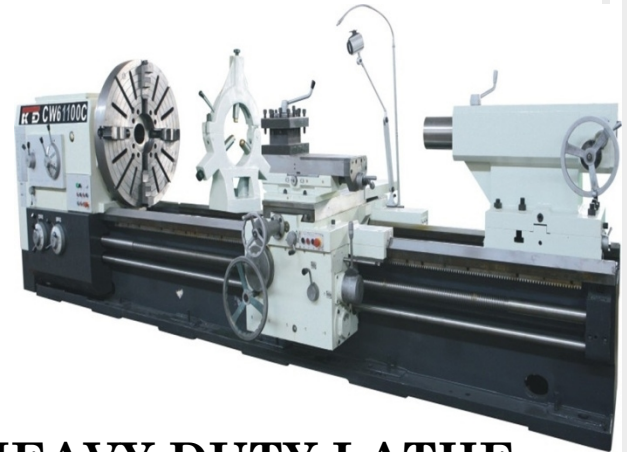

**HEAVY DUTY LATHE**



**GEAR SHAPER**



**SURFACE GRINDER**



**TIG WELDING**

# MACHINING CAPABILITIES

- Complete machining in 1 go/setup on **4-Axis VMC Machine**.
- Complete Machining on VMC through **3-D Software Program**.
- Complete Machining in combination of **CNC & VMC Machine**.
- **CNC Turned Parts, Precision Turned Parts , Threaded Parts**, Machining of various types of parts and material in various shapes on Advanced CNC Machines.
- **Material Cutting/parting operation** on Profile Cutting, Gas Cutting, Band Saw, Pipe Cutter Machines.
- **Material Machining/Shaping** and Blanking operations on Horizontal Milling, M1TR, VMC Machines.
- **Milling, Drilling, Slotting ,Counter**ing operation- VMC, M1TR
- **Tapping Operation** on Tapping, VMC and M1TR Machine.
- **Knurling and Teeth Cutting** operation on Gear Shaper Machine.
- **Welding operation** on TIG/MIG Welding Machine.
- **Grinding operations** on Surface Grinding & Centre less Grinding Machine.
- **Complete machining- Turning, Boring, Threading, Shaping, Facing** etc of Big and small Shaft ,Rotors, Rollers, Tie-Rods, Valve Body on Heavy Duty Conventional Lathe Machines.



# PARTNER CAPABILITIES

- **Nickel Plating**
- **Zinc Plating**
- **Anodizing**
- **Hard Chrome Plating**
- **Heat Treatment**
- **Induction Hardening**
- **Auto-Blackening**
- **Wire Cut & EDM Facilities**
- **Cylindrical Grinding**



# QUALITY ASSURANCE

- We have an In-built Quality lab, ISO 9001:2015 certified with top notch inspection equipment and come equipped with all the procedures required to conduct regular inspections of the manufactured products.
- Our team comprises of dedicated and qualified team of professionals with constant focus on Quality, Innovation, Engineering, Timely Solution and Customer Service and deep focus on our Quality assurance and enhancement plans for all products according to International quality standards and collaborators / customer specifications.
- All checks are painstakingly monitored by professionals in the field so that even the minutest mistakes catch their eye in order to be rectified. This helps us to maintain precision and quality along with a standardized process of machining.
- Our Quality Lab includes wide variety of general and specialized measuring instrument and gauges (see list below) with proper calibration from NABL certified labs with full compliance to national and international standards. We have the following facilities that aid us in the successful completion of our inspection:





# LIST OF MEASURING INSTRUMENTS & EQUIPMENT

- **Digital Air Gauge Unit - 01 Nos (Least Count- 01 Micron) - CK Gauges**
- **Hardness Tester-01 Nos- Saroj.**
- **Digital Height Gauge (0-600 mm)- Mitutoyo- 03 Nos**
- **Height Gauge (0-300 mm)- Aerospace- 02 Nos**
- **Slip Gauge Set(Grade 0/ Grade 1)- Mitutoyo**
- **Hydro testing M/c- ME**
- **Digital Vernier Caliper – Mitutoyo-For all Various Sizes.**
- **Vernier Caliper- Mitutoyo - For all Various Sizes**
- **Digital Micrometer- Mitutoyo Japan- For all Various Sizes**
- **Outside Micrometer - Mitutoyo- For all Various Sizes**
- **Bore Gauge- Mitutoyo- For all Various Sizes**
- **Digital Depth Gauge- Mitutoyo- For all Various Sizes**
- **Surface Plate- 03 Nos- 300 mm & 600 mm & 1 m- Bagson**
- **TPG- For all standard sizes & specialized sizes in UNC,UNF,BSP,BSPT etc.**
- **TRG- For all standard sizes & specialized sizes.**
- **Measuring Pins- Standard & customized sets for different components**





DIGITAL AIR GAUGE UNIT



BORE GAUGE

DIGITAL HEIGHT GAUGE



OUTSIDE MICROMETER

HARDNESS TESTER

SLIP GAUGE SET



DIGITAL DEPTH VC



DIGITAL MICROMETER



DIGITAL VERNIER CALIPER



HEIGHT GAUGE

# **HOW WE WORK TO DEVELOP YOUR COMPONENTS**

***Understanding the customer's need and requirement in depth for development of component or parts.***

***Proper analysis of Drawing, Design or sample as per specs and establishing the initial process for manufacturing.***

***Cost Effective procurement of general or specialized material (Tested OK) and special gauges (if any) as per design with allowance for machining.***

***After Sample approval, A pilot Lot may be taken to better establish quality parameters and process sheet through customer feedback and continuous R&D and Reverse Engg. to best meet quality standards and cost target.***

***Machining and other partner operations (HI etc) as per process sheet through our in-house machines and partner capabilities with complete supervision of our quality department as per set quality standards.***

***Metal Finishing operations like Hard Chrome, Nickel, Zinc, Auto-Black etc to be carried out as per specs (if required) at our reputed partner facilities.***

***After PDI, parts are packaged as per instructions for safe travel of material to destination.***

# WHY CHOOSE PROLIFIC ENGINEERS ?

- Complete machining solution through advanced Machines.
- An ISO 9001:2015 certified company.
- Flexibility in small batch manufacturing.
- Proven track record of working with major OEM'S.
- Complete focus on quality and customer service
- Expertise in understanding of American, European & Korean Standards.
- Customized Assembly components with part assembly capabilities
- Continuous improvement initiatives and investment.
- We have in-house fabrication section
- Best-in-class Project Monitoring.
- Best-in-class Resource Planning.
- Immense knowledge and experience of Manufacturing Die, Moulds, Tools & Fixtures also.



# VARIOUS COMPONENTS WE MAUFACTURE

- The best reflection of our company is in the components we manufacture for our customers. From components with exacting tolerances upto 10 microns to heavy machining jobs with variable sizes and lengths.
- Our In-house fabrication and machining sections enable us to deliver components in a timely manner while continually maintaining and improving our quality standards.
- We are currently manufacturing and supplying components for our existing customers for the following sectors-
  - Components for Key Cutting Machine & Futura Machine for Automobile.
  - Components for Equipment of Railway and Metro Tracks, Engine, Connector Assembly, Convertors of Locomotives, Panels, Tap Changer, Machine Contactor.
  - Components for Manufactures of Packaging machines of – Aseptic Liquid, Film, Flexible, Multi-Track Machine, Collar Type Machine, Lined Carton, Case Packaging, End of Line Packaging, Bottle Filling Machine.
  - Components for Manufactures of Plants for
    - Soap Bars, Liquid Soaps, Detergents, Fatty Acid, Glycerin Distillation.
    - Components for Manufacturers of Material Testing Instruments- Cement, Concrete, Condition Monitoring Systems.
    - Components for Manufactures of Hydraulic winches, Tower Crane Winch, Winch Drive Systems.
    - Components for Manufactures of Industrial and Food Grade Screw Pumps and Gear Pumps.
    - Components for Manufactures of Hydraulic Lifts, 3-point coupling, Tractor Industry Equipments.
    - Components for Manufactures of Extruders and compounding Machines, Rotary and Diverter Valves, Hoppers for Plastic Processing Industries.
    - Components for Manufacturers of Complete Pneumatics Systems- Cylinders, Valves, Actuators etc
    - Components for Manufacturers of 3-point Linkage across market.
    - Manufactures of Weld Neck Flanges, Blind Flanges, and Couplings across India.
    - Manufactures of Fabricated Rotors and Shafts to many companies in India.





**Flanges we currently manufacture**



**Base & Carriage for Key Cutting Machine with  
parallelism and tolerance of holes in 10 microns.**





**Critical Shaft of Railway Equipment.**







**Bajonet Ring, Coupling Nut, Receptacles & Backshells for Railway's connector assembly**

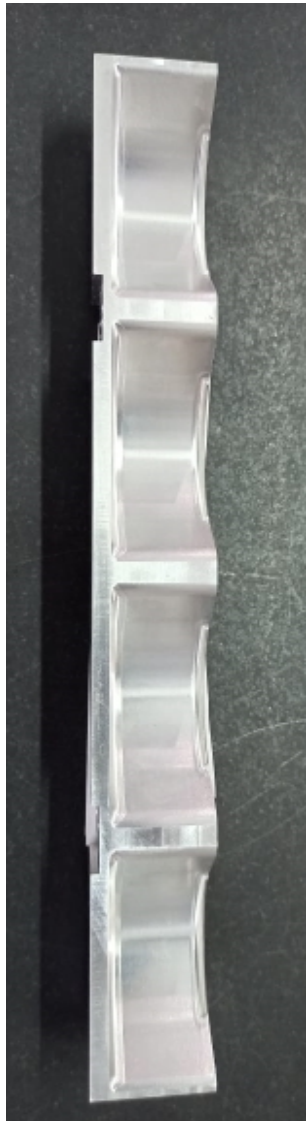

**Components for Packaging Machine  
Manufacturer**



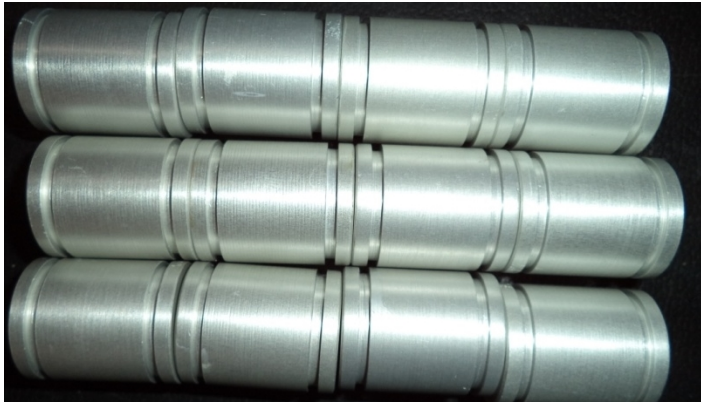
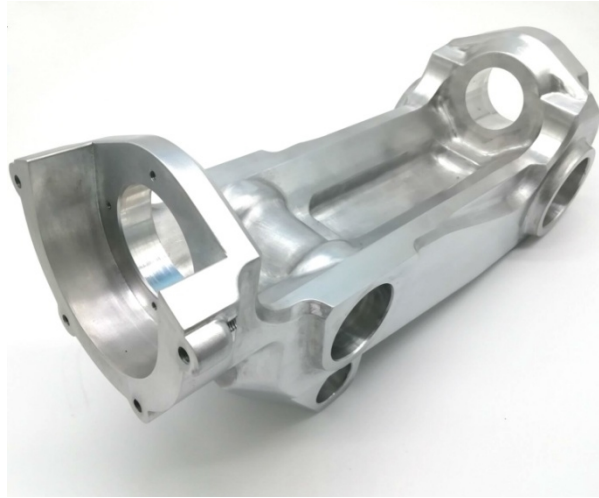

○ Components for Packaging Machine Manufacturer



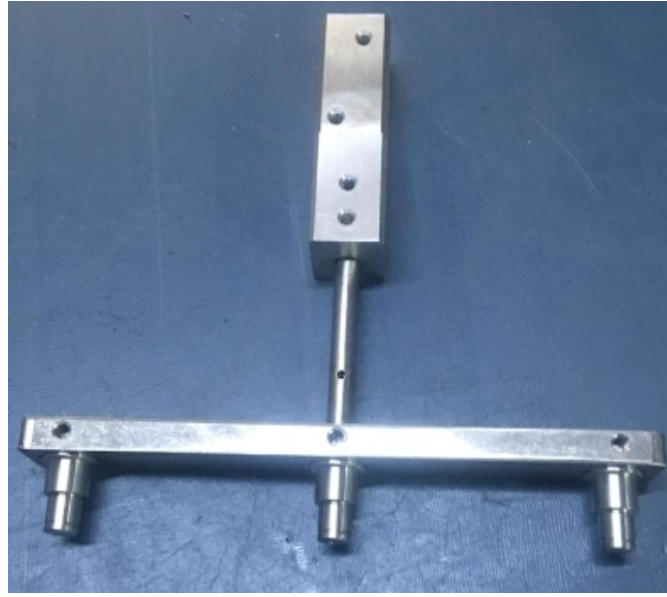
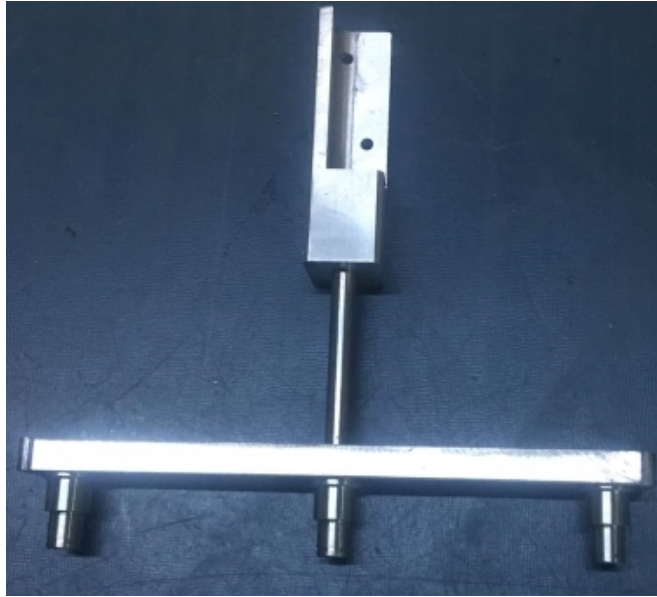

- Critical Assembly of Cutter for Soap Plants





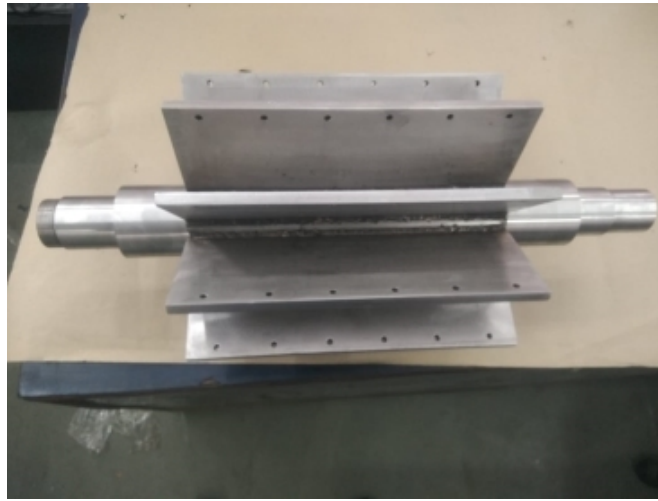

**Fabricated Rotors & Shredder Blades for Soap Plants.**





- Critical Assembly for Manufacturers of Hydraulic Winches





**Components of Pneumatic Systems**  
**Manufacturer**







- Valve Body for Plastic Process Industry





# WE ARE SERVING TO FOLLOWING CATEGORIES OF INDUSTRIES



Auto Industry

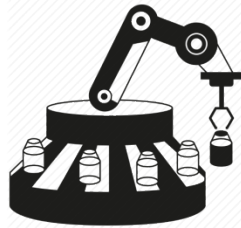

Packaging



Railways & Metros

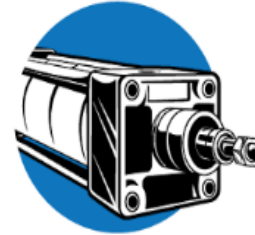

Pneumatics



Material Testing Equipment

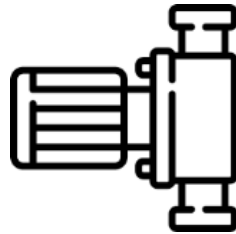

Industrial Pumps



Industrial Valves



Soap & Detergent Plant Manufacturers

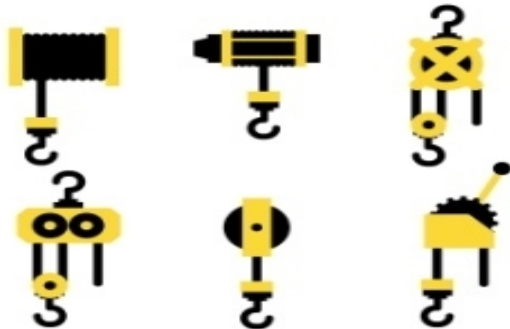

Hydraulic & Tower Crane Winches



Manufacturer-Flanges, Couplings & Nuts



Fabricated Items

# OUR CLIENTELE

- Our customers include companies operating in the following sectors-
- Packaging Industries- Packaging of Aseptic Liquid, Flexible, Film, Multi-Track, Collar Type, Lined Carton, Case, End of Line, Bottle Filling.
- Automobile Industries- Manufacturers of Hydraulic Lifts, 3 point couplings, 3 point linkages, Key Cutting Machine, Car Key Shell, Tractor Components.
- Soap & Detergent Plant Manufacturers- Manufacturers of Complete Plants for Soap, Detergent, Fatty Acid, Glycerine Distillation.
- Railways & Metros- Manufacturers of Equipment for Railways & Metros- Bogey Connector Assembly, Tap Changer, Convertors for Locomotives coaches, Switchgears, panels, Earthing Switch, Machine Contractors and Monorail Assemblies.
- Winch- Manufacturers of Hydraulic Winch, Tower Crane Winch, Winch Drive.
- Material Testing Instruments- Manufacturers of Cement, Concrete and other Material Testing Instruments, Condition Monitoring Systems.
- Industrial Pumps- Manufacturers of Screw Pumps, Gear Pumps, Food Grade Pumps.
- Industrial Valve- Manufactures of Extruders and compounding Machines, Rotary and Diverter Valves, Hoppers for Plastic Processing Industries.
- Flanges- Manufactures and exporters of Weld neck Flanges, Blind Flanges, Motor Flanges, Couplings and Nuts.
- Pneumatics- Manufacturers of Complete Pneumatics Systems- Cylinders, Valves, Actuators etc

# OUR CLIENTELE



We look forward to serving your esteemed company to the best of our capabilities.

Thanking You,

**Prolific Engineers**

(Contact Person & No.- Satish Upadhyaya, 9811082400)

**Email-** [satish@prolificengineersindia.com](mailto:satish@prolificengineersindia.com)  
[prolific\\_engineers@yahoo.co.in](mailto:prolific_engineers@yahoo.co.in)

or

**Address-** Plot No. 362, Udyog Kendra 1<sup>st</sup> Extn, Ecotech III ,  
Greater Noida

